

Stick Me

SELF-ADHESIVE VINYL PLANK

INSTALLATION INSTRUCTIONS

REQUIREMENTS FOR THE SURFACE

The height difference in the floor structure should be within a tolerance limit of maximum 1 mm. Otherwise, there may be irregularities between the individual vinyl sheets and a ripple effect may occur after installation.

If the height differences in the floor structure are too great, it is advisable to apply a levelling compound before laying the vinyl tiles. If the vinyl is to be glued down, the moisture in the floor and walls (if any) must be in an acceptable range. Otherwise, it is advisable to apply a water-repellent primer before gluing.

Uneven wall surfaces create gaps between the vinyl and the wall, so it may be necessary to cover these after installation. In this case, a skirting board should be applied

PREPARATIONS

- Always store vinyl flooring boards lying flat and not upright.
- Allow the new flooring to acclimatise for at least 24 hours before installation in the room where it is to be installed.
- Prepare all tools needed for the installation of the floor covering.
- Before installation, remove flooring accessories such as skirting boards, panelling or other fittings and covers that could interfere with the installation of the new floor.
- The floor surface must be clean, dry and stable.
- Paint, dust, debris, and other dirt must be removed from the floor before installation.
- The floor must be absolutely level and should be smoothed with a scraper or trowel.
- Before installing the floor, check whether the door can still be opened and closed after installation (minimum 1 cm space).

INSTALLATION

- The room temperature should be in the range of 18–25 °C during installation.
- Be careful to keep the subfloor clean and completely dry at all times during installation.
- Store mobile parts such as furniture and appliances outside the room during installation.
- To ensure optimum adhesion of the adhesive, the already laid floor should be rolled every 30 minutes until it reaches its final strength.

VINYL ADHESIVE FLOORING

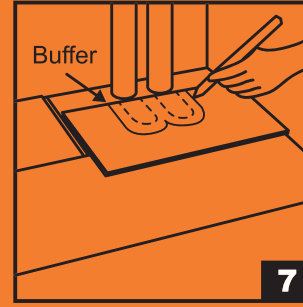
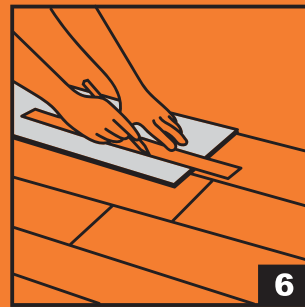
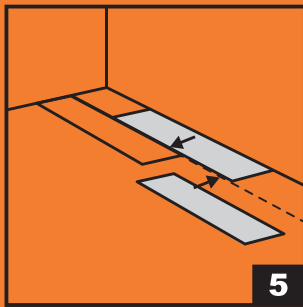
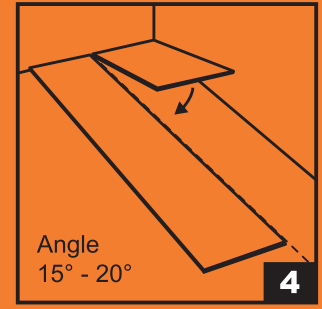
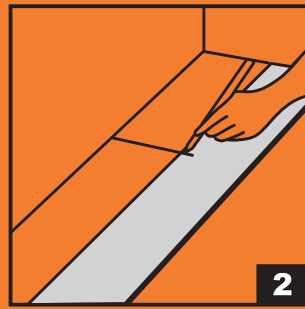
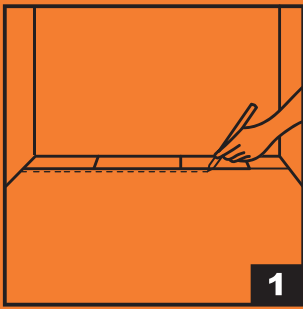

1. Start on one wall of the room and place a row of panels first without gluing them. Leave an expansion gap of 2-3 mm between the wall and the flooring. Align the row straight and mark the front edge.
2. Mark the required length on the last panel in the row. Use a ruler and a cutter knife to cut the panel.
3. Start with the first panel in the second row and glue it in front of the marked edge.
4. Then place the cut-off from the last panel of the first row above the first panel of the second row at an angle of 15° to 20° and glue it in place.
5. Glue the remaining panels of the first two rows alternately along the marked edge to guarantee a straight installation. To obtain a stable bond, start the next row again with a cut. Lay the rest of the floor row by row.
6. To fit the last row, place the panels on top of the penultimate row up to the wall as shown in picture 6. Take a board or ruler and place it vertically and parallel to the edge of the bottom row over the end panel. Then mark and cut the panel to the determined width and glue it in place.
7. Heating installations such as valves and pipes require an expansion buffer. First cut the panel to the correct length. When the cut panel is in the correct position, measure and mark the cut-out with a ruler and the addition of a sufficient buffer distance.
8. The gap between the bottom of a door and the floor covering should be 1 cm. To shorten the door frame, it is recommended to place an inverted panel next to the frame as shown in figure 8. Use a suitable saw placed flat on the inverted panel to saw off the door frame at the appropriate height. The panel should then slide easily under the frame.